

2-4 Piston

2-4 Clutch

Low/Reverse Clutch

F

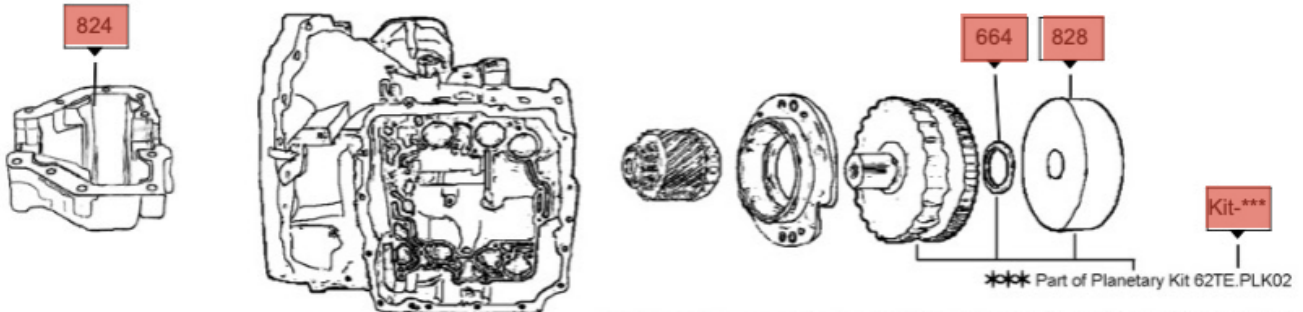

Pinion Gear, Output Shaft & Underdrive Ring Gear

G

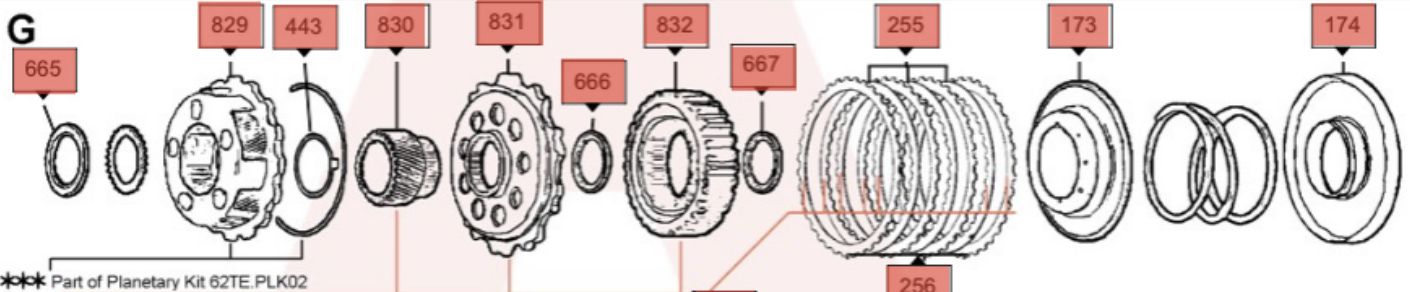

Planetary, Sun Gear & Hub

U.Drv Direct Clutch

H

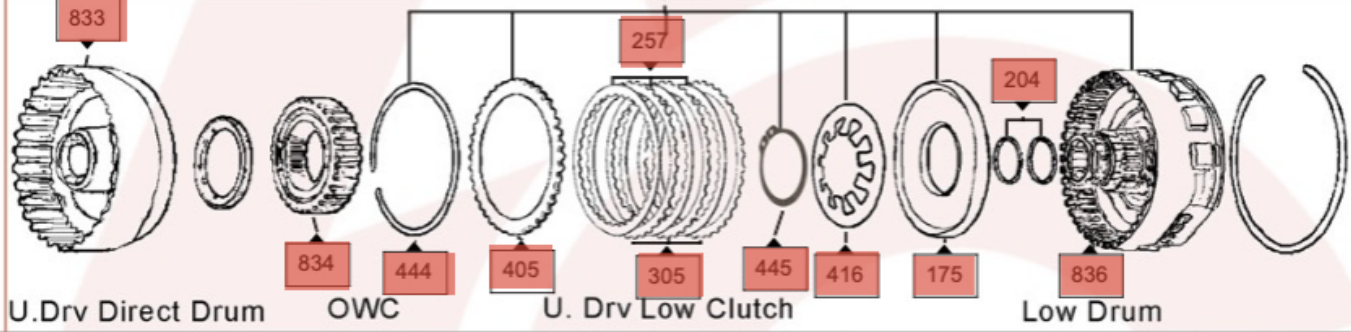

U.Drv Direct Drum

OWC

U. Drv Low Clutch

Low Drum

J

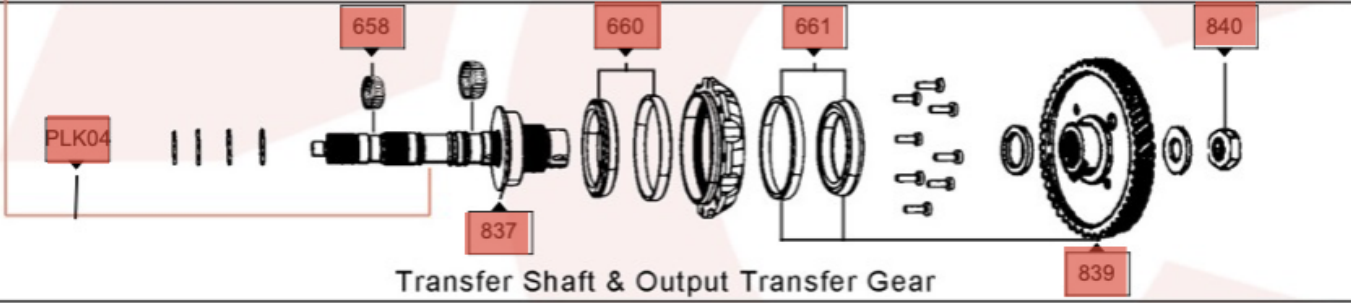

Transfer Shaft & Output Transfer Gear

K

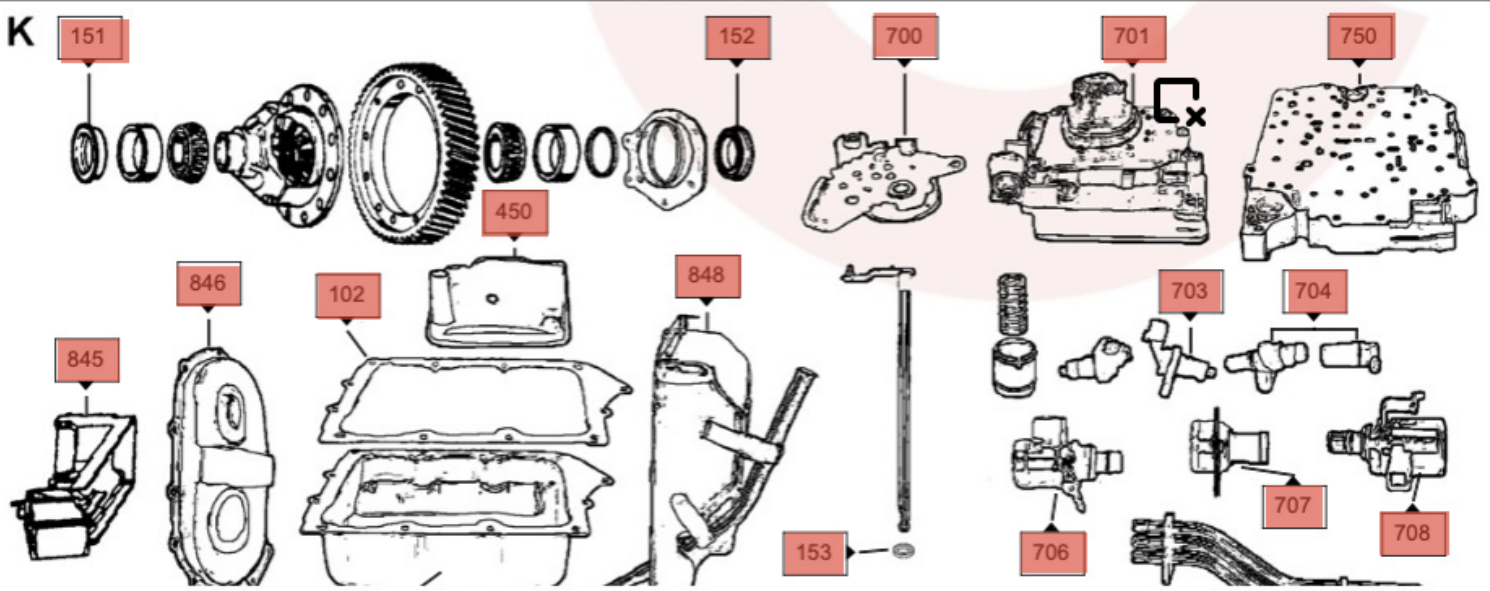

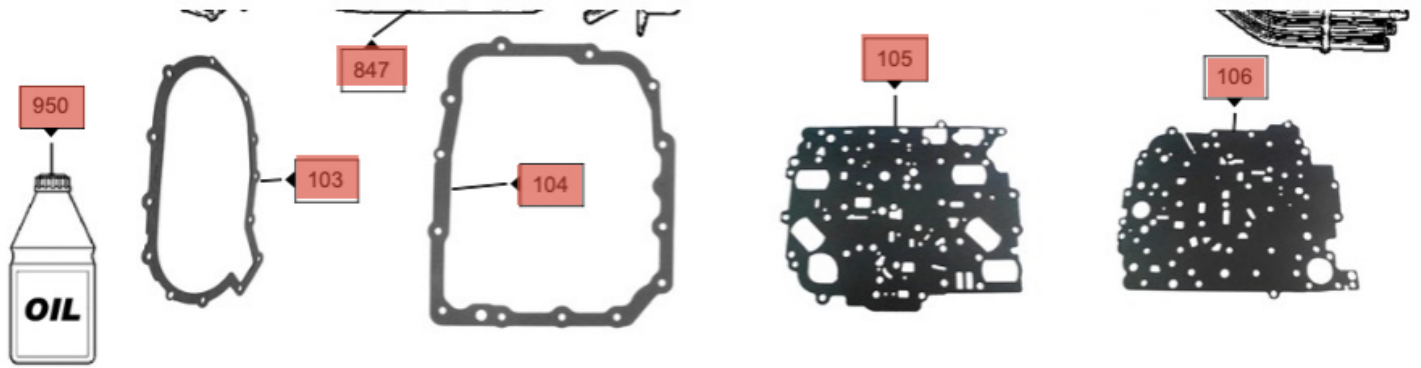

Diff, Oil Pans, Valve Body, Sensors, Solenoids Etc.

