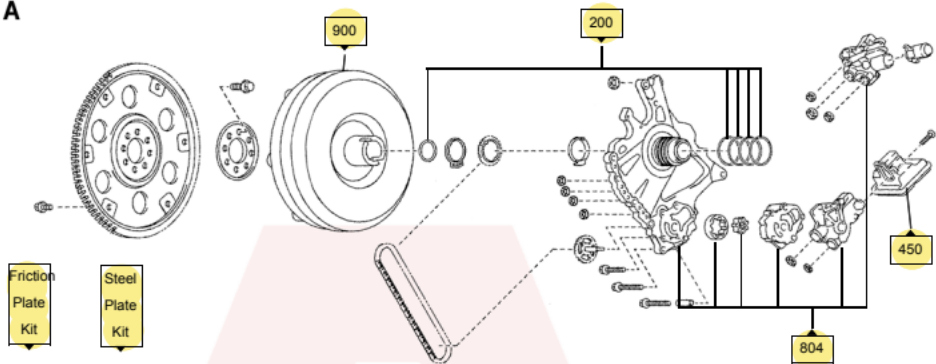
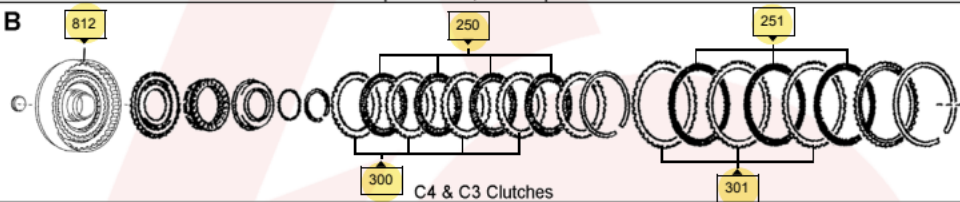
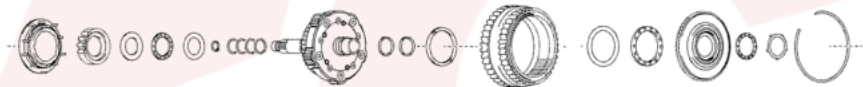
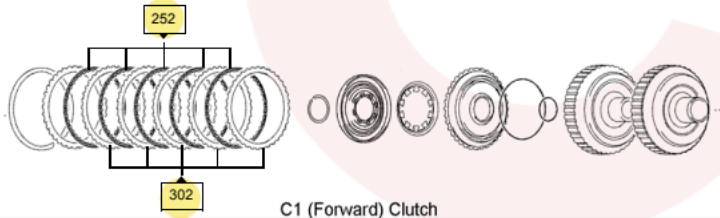
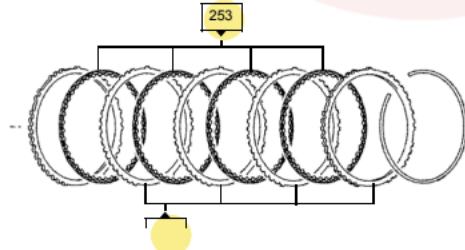

A

Torque Convert, Oil Pump & Filter

B**C**

Front Sun Gear, Front Planetary, Ring Gear & Flange

D**E**

303 B1 Brake

F

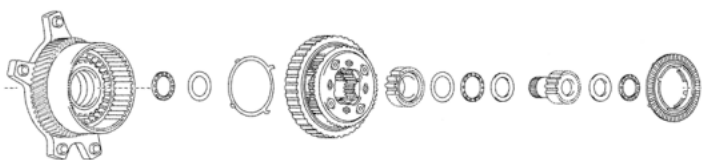

Counter Shaft Drive Gear, Rear Planetary & Sun Gears

G

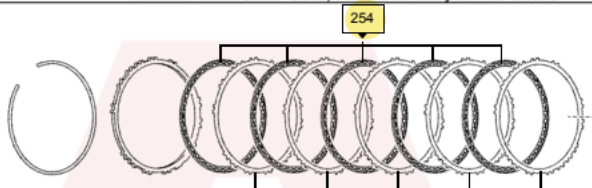

B2 Brake (1st & Reverse)

H



B2 Piston

J

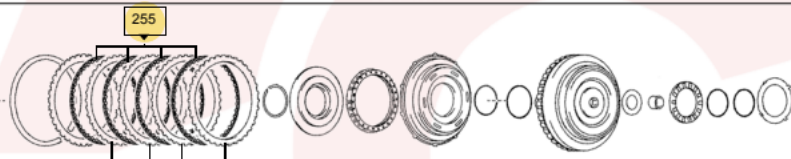

C2 Clutch (Direct)

K

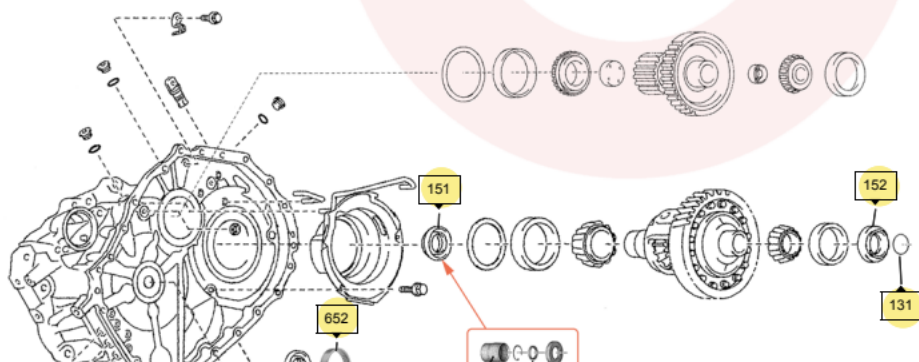

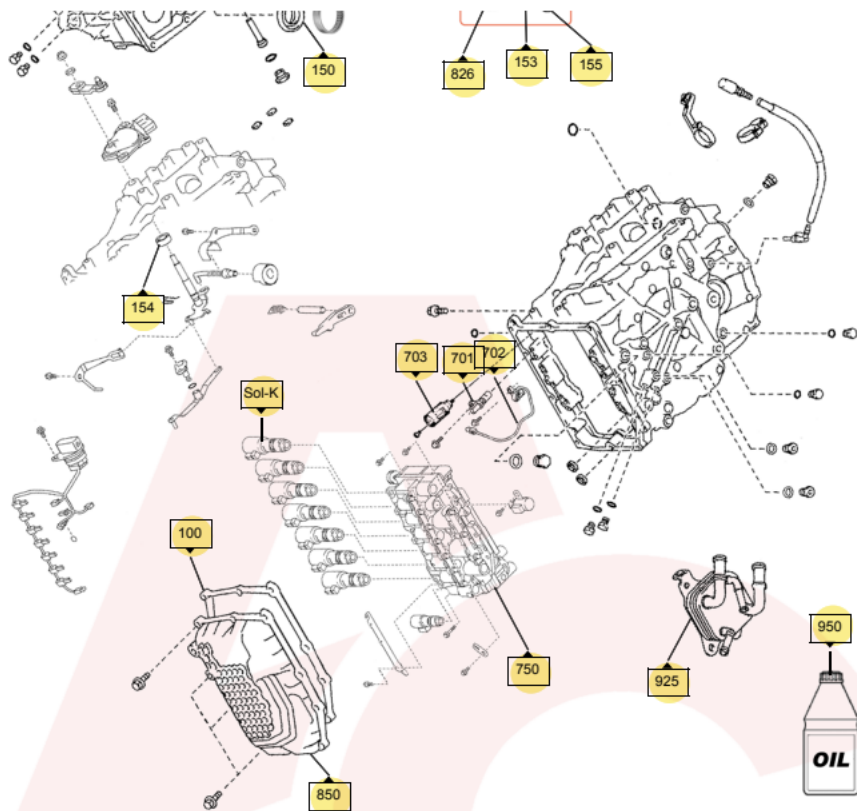

Casings, Differential, Counter Shaft and Valve Body Etc.

L

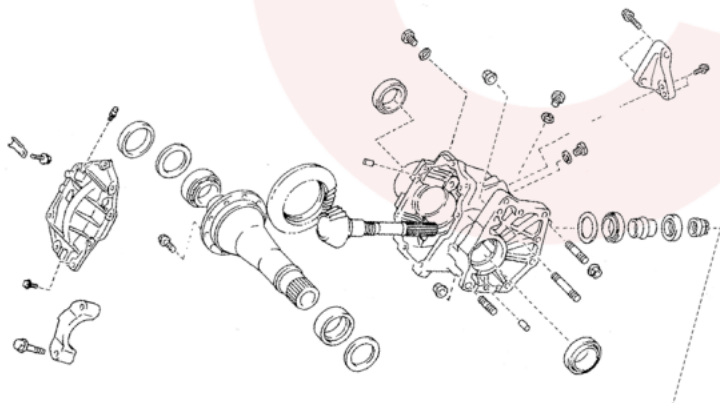

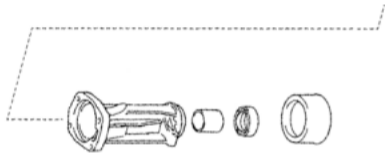

AWD Transfer Case

ACE